

LODE MRI ERGOMETER

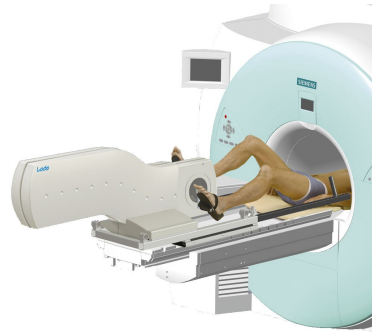

FEATURES & BENEFITS

- Unique ergometer
- Usable for several examinations and research
- Exercise is recommended over pharmacologic stress
- Compatible with MRI scanners of Siemens, Philips and GE
- Several movement options: pedal, push/pull, up/down & ankle flexion
- Accurate over a long time of period
- Reliable and reproducible stress tests
- Extreme low start-up load
- Zero load is < 5 watt at 25 rpm
- Adjustable in steps of 1 watt
- Various test modes and possibilities
- Adjustment according to your specific wishes possible
- Available with software to control the ergometer
- Optional rebuilding sets
- Tesla independent
- Easy to move and position
- Silent during operation
- Service friendly
- High standards
- A reliable product of Lode BV, *the* standard in Ergometry

The Lode logo, featuring the word 'Lode' in a stylized, blue, cursive font.

the standard in Ergometry

LODE MRI ERGOMETER

The MRI ergometer is an ergometer for use during MRI studies. The MRI ergometers workload is controlled with an electrical braking principle especially designed for use in a MRI environment. The moment of inertia is very low. The MRI ergometer is standard supplied with a control unit and power unit. The standard control unit offers the possibility to read out various parameters like workload, rpm, torque, timer and distance. The power unit is completed with a safety cable for wallfixation. The MRI ergometer can be used for MRI scanners up to 3 Tesla. .

The MRI ergometer can be used for cardiac examinations, cardiac research, spectroscopy and other examinations and research.

Movements



Pedal

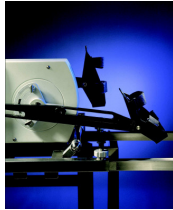

Up/down



Push/Pull

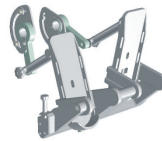

ankle flexion

For **cardiac MRI examinations**, the MRI ergometer can be produced with a pedal (circular) or push/pull exercise movement.

For **spectroscopy MR examinations** there is an ergometer available with up/down movement for the upper leg and an ankle MRI ergometer for the calf muscles.

There are several rebuilding sets: up/down to push/pull and reverse, up/down to ankle and reverse and push/pull into ankle and reverse.

The MRI ergometers are compatible with most types of MRI scanners of Siemens, Philips and GE. For more information about this unique ergometer, please contact Lode BV.

Lode B.V.
Zernikepark 16
9747 AN Groningen
The Netherlands
Tel.: 31(0)50 5712811
Fax: 31(0)50 5716746



ISO 9001 and ISO 13485 certified
e-mail: ask@lode.nl
<http://www.lode.nl>

